

# Emys

## Technical sheet

English

Download  
the Guide  
at:  
[www.tartadesign.it](http://www.tartadesign.it)

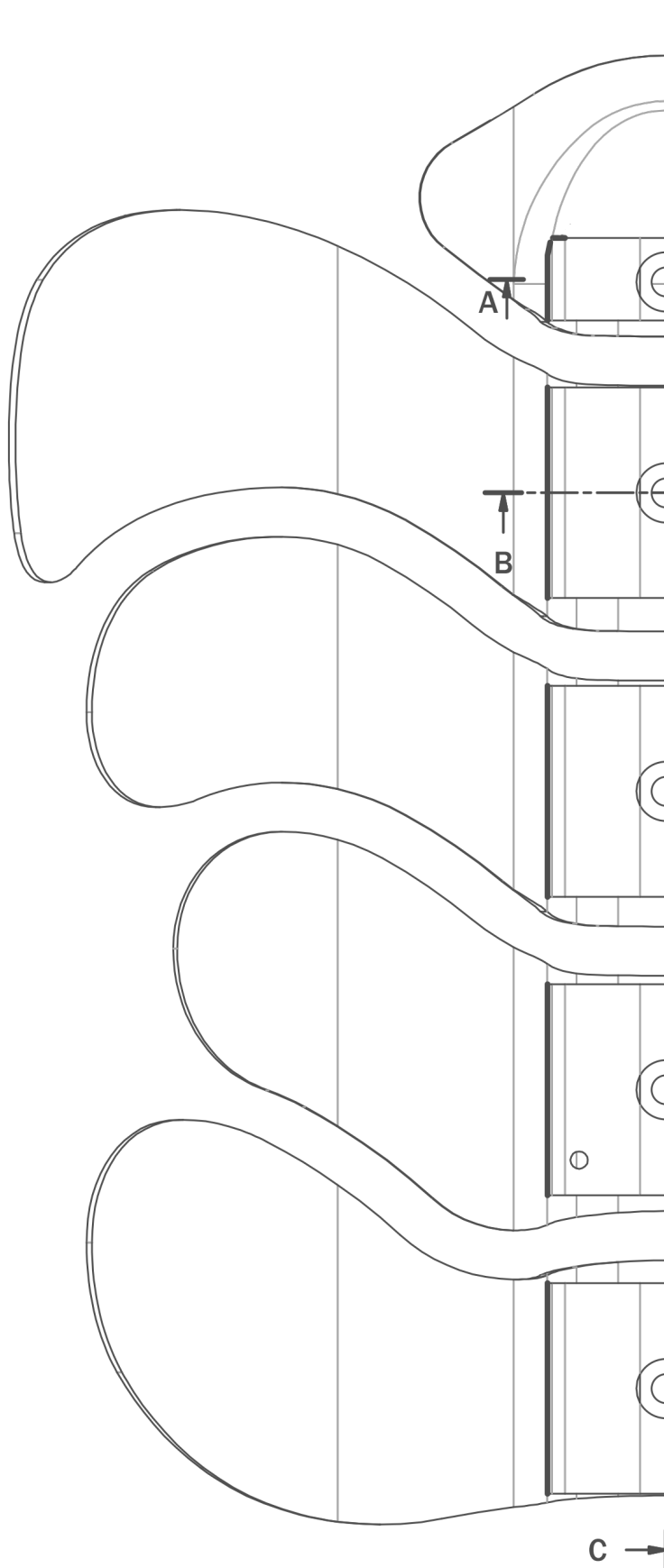



## Main features

### Comfort

Each pad is made of foam, with a removable and washable covering realized with technical material for maximal comfort.

### Design

Minimal and soft lines highlight an hi-tech design blending beauty and ergonomics.

**New:** discover the high-visibility stripes for your safety.



### Fresh feel

The space between the slats and the specific materials used for the pads, make the backrest highly breathable.

### Flexibility

The central armonic spring steels and the modular system, allow the backrest to flex giving freedom of movement to the user.

**New:** with EMYS you can decide the level of flexibility of the backrest!

## Height

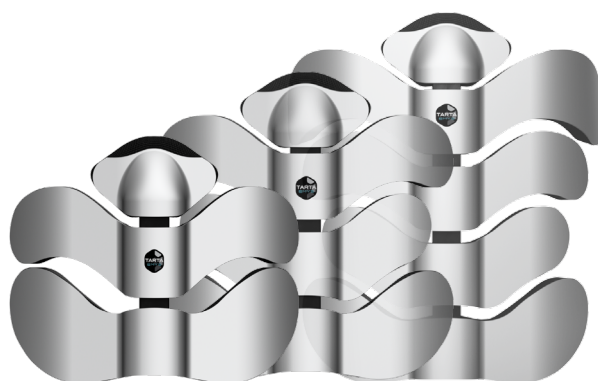

3V 4V 5V

- | 3 Vertebrae 27 cm
- | 4 Vertebrae 35 cm
- | 5 Vertebrae 43 cm

## Size

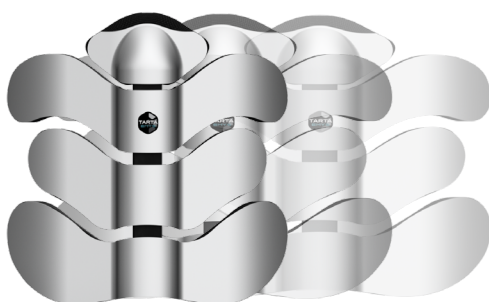

M L XL



- | **M** for wheelchairs from 35 to 40 cm



- | **L** for wheelchairs from 38 to 43 cm



- | **XL** for wheelchairs from 40 to 45 cm

## Depth



**STANDARD**

5,5 cm



**CONTOUR**

9 cm









**DEEP-CONTOUR**

14,5 cm

Aluminum is the most adaptable material to make each slide of the backrest suit the user's body!



	STANDARD	CONTOUR	DEEP-CONTOUR
3V M-L-XL			/
4V M-L-XL			
5V M-L-XL	/		



1 Press



2 Press to bend the staff.  
Maximum excursion 3 cm.

3 heights  
3 sizes  
3 depths

**21 models**







## Adjustable clamp for rigid frame wheelchairs

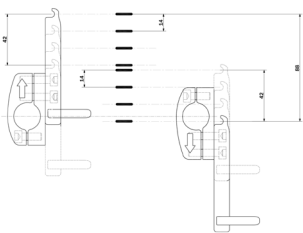
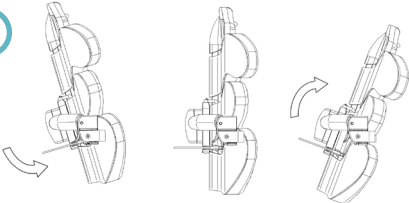
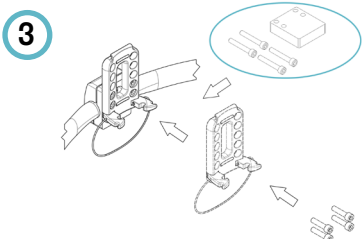
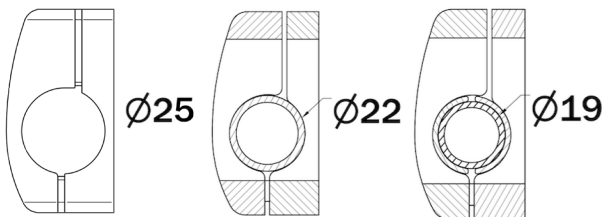
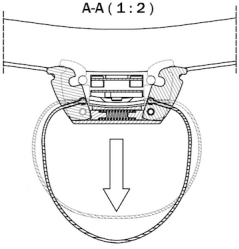
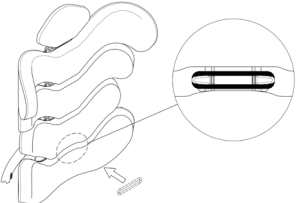

### Features:

- ① height adjustment
  - ② rotation adjustment
  - ③ depth adjustment
  - ④ tube diameter: 19-22-25mm
  - ⑤ easy unhook
  - ⑥ safety rubber band
- 
- 
- 
- 
- 
- 
- A-A (1:2)



## Adjustable clamp for folding wheelchairs

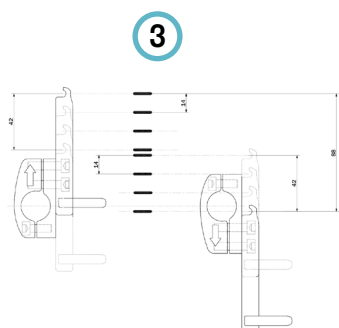
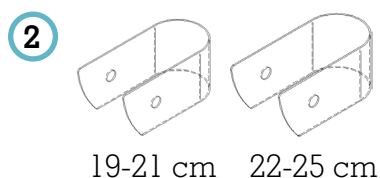
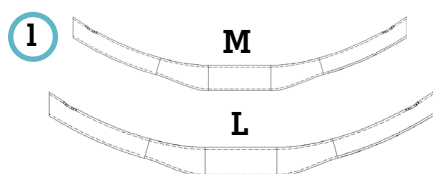
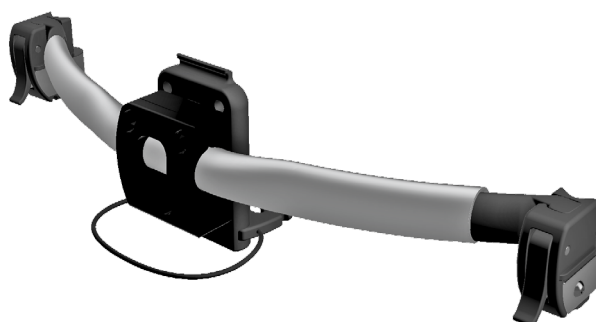

### Features:

- ① rigidizer bar to specify:  
**M:** 36 - 41 cm    **L:** 41 - 46 cm
- ② hose clamp: 19-21 / 22-25 mm
- ③ height adjustment
- ④ depth adjustment
- ⑤ rotation adjustment
- ⑥ easy unhook
- ⑦ safety rubber band

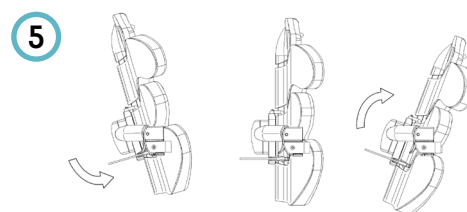
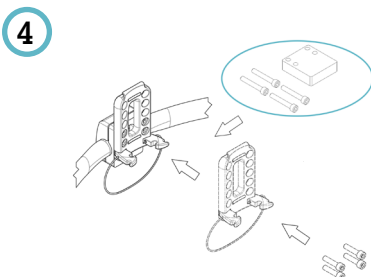
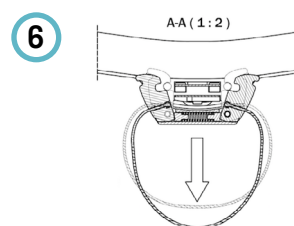
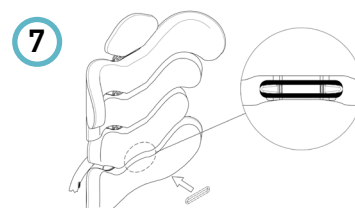



## Finishing



**"A" bent slat**  
for a **more comfortable**  
**support.**

### Upper pocket pads

for a greater adherence to the slats and to **intensify the softness** of the backrest.

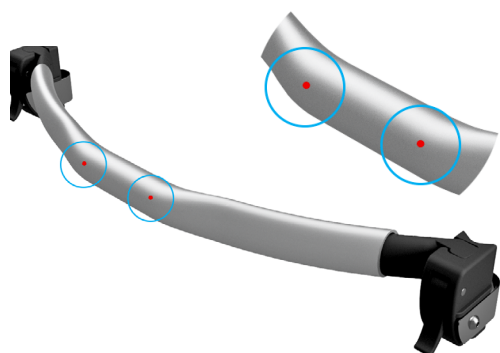

### Balance points

on the rigidizer bar to simplify the balance of the clamp for folding wheelchairs.

### 2 rubber tubes (internal diameter 22mm)

easy adaptables to every wheelchair **to protect the backrest.**



### Highly breathable pads

removable and **washable** at 30°.



Choose your **style.**





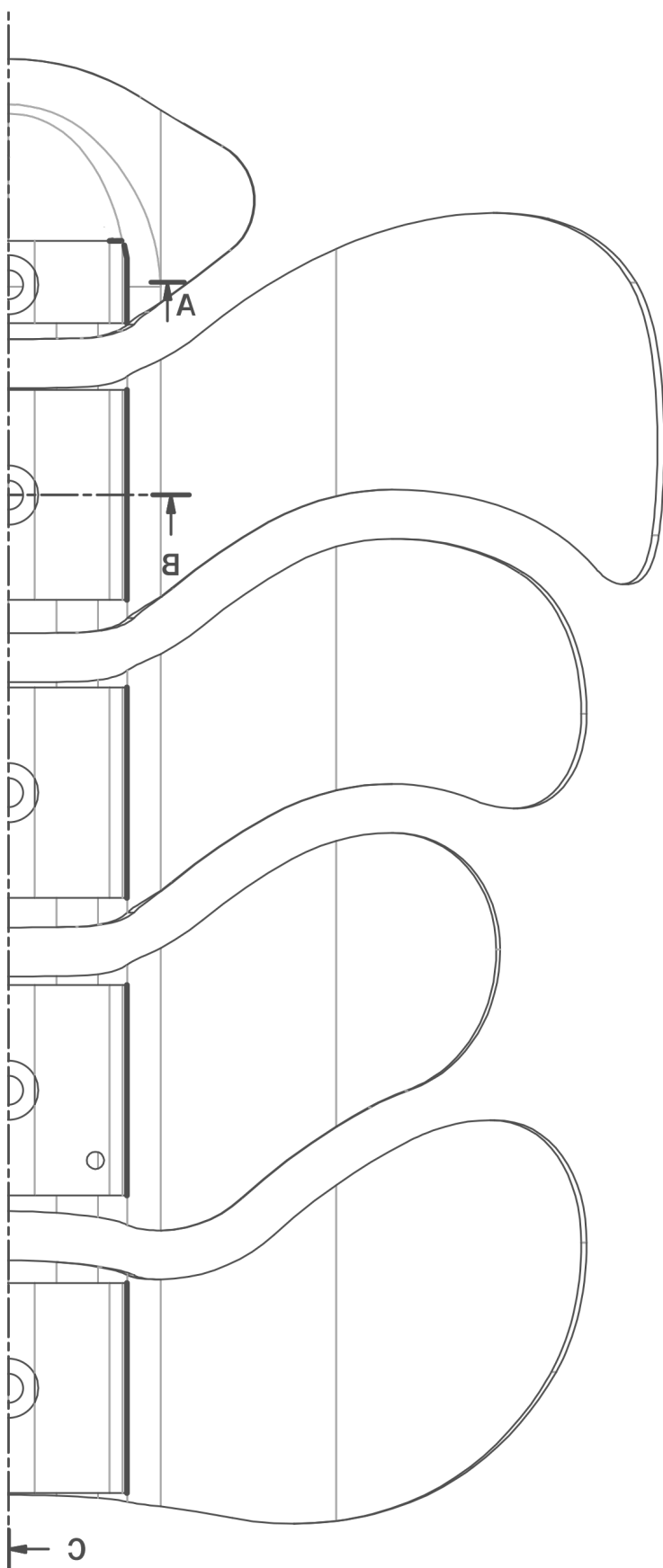

Questions?  
Info?  
Help?

Visit our website:  
**[www.tartadesign.it](http://www.tartadesign.it)**

or contact us at:  
**[info@tartadesign.it](mailto:info@tartadesign.it)**



### **Tarta Design srl**

Via Cotonificio, 56  
33037 Pasian di Prato  
Udine - Italy  
T +39 0432 722 533  
F +39 0432 542 920

**[www.tartadesign.it](http://www.tartadesign.it)**  
**[info@tartadesign.it](mailto:info@tartadesign.it)**